



**DONAHUE**  
**ASSOCIATES**  
 COMMERCIAL REAL ESTATE ADVISORS

802-862-6880

www.donahueassociatesvt.com

**FOR LEASE/  
 RETAIL SPACE**

Maple Tree Place,  
 Williston, VT 05452



**SUMMARY**

**Available Suites**

**Pad Site**—1,531 SF

**Building A**—9,297 SF

**Building B**—1,616 SF

**Building C**

Suite 110 : 2,000 SF

Suite 120: 2,061 SF

Suite 130: 2,061 SF

Suite 170: 2,345 SF

**Building D**

Suite 110—1,485 SF

Suite 120—1,520 SF

Suite 130—665 SF

Suite 190—1,995 SF

**Overview:** Maple Tree Place is favorably positioned in the market and includes an attractive mix of dining, shopping, and entertaining with a state-of-the-art movie complex and family-friendly events. With a strong mix of retailers including the Christmas Tree Shops, Shaw's, Best Buy, Ulta, and Dick's Sporting Goods, Maple Tree Place continues to attract an audience from both local and neighboring areas.

**Lease Price:** TBD

**Other Tenants Include:** Christmas Tree Shops, Dicks Sporting Goods, Best Buy, Ulta, Carter's, Shaw's, Majestic 10, Old Navy, Chili's, Staples, & many more!

**Parking:** Ample on-site parking

**Zoning:** Taft Corners Zoning District - approved uses include, but are not limited to, Retail, General Office, Medical Office, Family/ Child Care, Arts, Entertainment, and Recreation.

**CONTACT US**

**Donahue & Associates**

(802) 862-6880

www.donahueassociatesvt.com

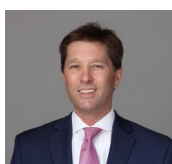

**Steve Donahue**

Steve@donahueassociatesvt.com

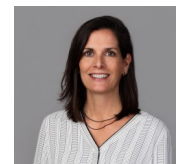

**Meg McGovern**

Meg@donahueassociatesvt.com



**DONAHUE**  
**ASSOCIATES**  
COMMERCIAL REAL ESTATE ADVISORS

# FOR LEASE/ RETAIL SPACE Maple Tree Place, Williston, VT

## CENTER PHOTOS



**FOR LEASE/  
RETAIL SPACE**  
**Maple Tree Place, Williston, VT**

**RETAIL PAD SITE**



**Power Center PAD SITE next to Starbucks Coffee!!**

*30 Hawthorne Street*

**Suite Size—1,531 square feet**

**Overview:** Suite offers great natural light, side entrance, parking right in front and an open layout.





**DONAHUE**  
**ASSOCIATES**  
 COMMERCIAL REAL ESTATE ADVISORS

**FOR LEASE/  
 RETAIL SPACE**  
**Maple Tree Place, Williston, VT**

**FLOOR PLAN**

**Building A**

*184-186 Boxwood Street—*

9,297 SF Available

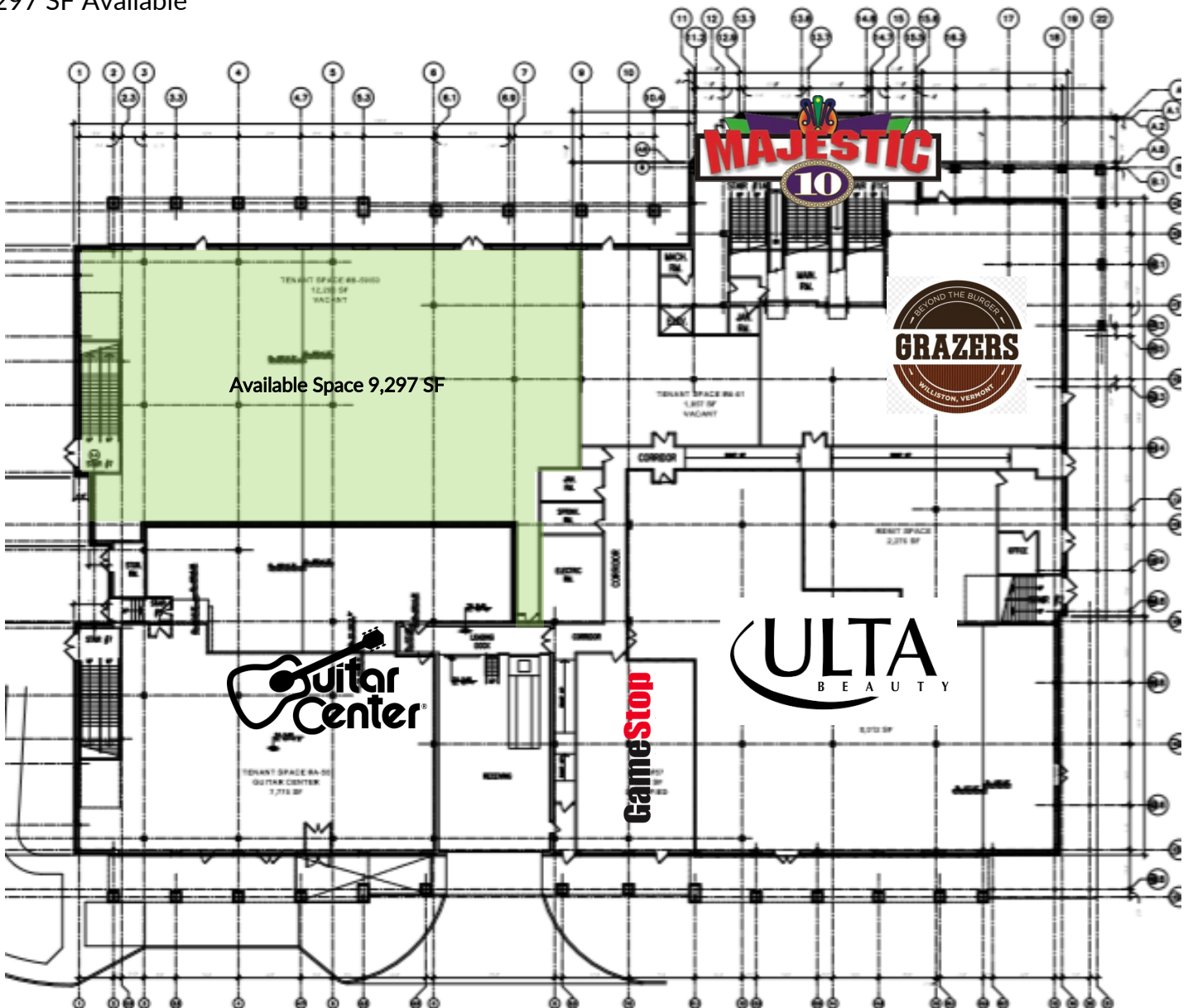

**FOR LEASE/  
 RETAIL SPACE**  
**Maple Tree Place, Williston, VT**

**FLOOR PLAN**

**Building B**

*16 Walnut Walkway—1,616 SF available*

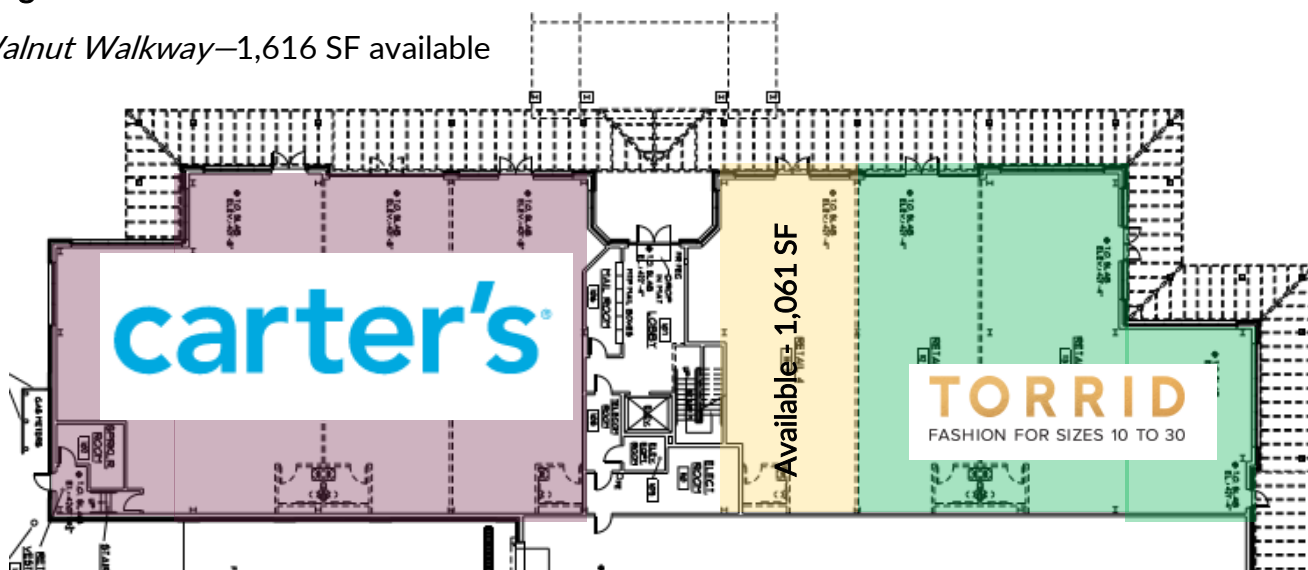

**Building C**

*28 Walnut Street*

Suite 110 - 2,000 SF

Suite 120 - 2,061 SF

Suite 130 - 2,061 SF

Suite 170 - 2,345 SF

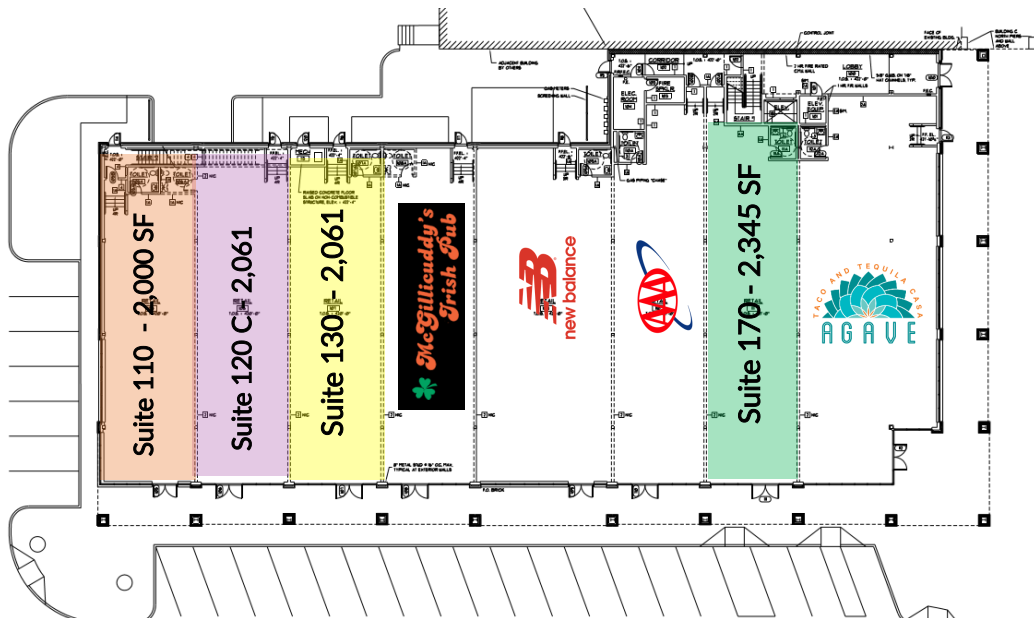



# FOR LEASE/ RETAIL SPACE

## Maple Tree Place, Williston, VT

### FLOOR PLAN

#### Building D—

166 Sycamore St

Suite 110—1,485 SF

Suite 120—1,520 SF

Suite 130—665 SF

Suite 190—1,995 SF

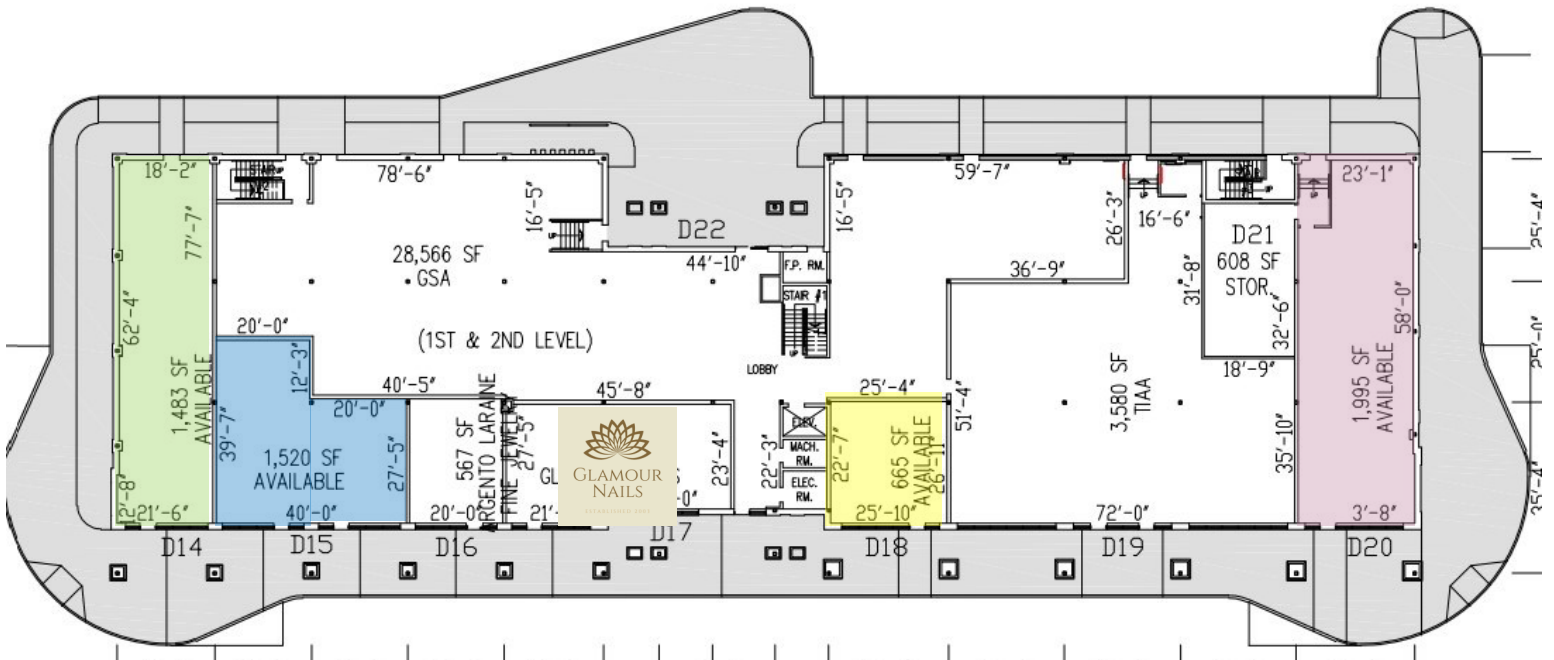



**DONAHUE**  
ASSOCIATES  
COMMERCIAL REAL ESTATE ADVISORS

FOR LEASE/  
RETAIL SPACE  
Maple Tree Place, Williston, VT

CURRENT TENANTS



Vermont  
Sandwich  
Company, Inc.

